

# Panasonic<sup>®</sup> INSTRUCTION MANUAL

## Inductive Proximity Sensor GX-F/H Series

Thank you very much for purchasing Panasonic products. Read this Instruction Manual carefully and thoroughly for the correct and optimum use of this product. Kindly keep this manual in a convenient place for quick reference.

### ⚠ WARNING

- Never use this product as a sensing device for personnel protection.
- In case of using sensing devices for personnel protection, use products which meet laws and standards, such as OSHA, ANSI or IEC etc., for personnel protection applicable in each region or country.

### 1 CAUTIONS

- This product has been developed / produced for industrial use.
- Make sure to check the wiring as wrong wiring will damage or burn the product.
- Do not use during the initial transient time (50ms) after the power supply is switched on.
- Extension up to total 100m is possible with a 0.3mm<sup>2</sup>, or more of conductor cross-section area cable.
- Tightening torque to mount this product is shown as following table.

Model No.	Using screw	Tightening torque
GX-F8□, GX-H8□	M3 truss head screw	0.7N·m or less
GX-F12□, GX-H12□	M3 pan head screw	0.7N·m or less
GX-F□15□, GX-H□15□	M3 pan head screw	1.0N·m or less

- When mounting GX-F6□/H6□, use the sensor mounting bracket (optional). M3 screw and nut are not accessory so prepare them by yourself.
- When mounting GX-F8□/H8□, GX-F12□/H12□, or GX-F□15□/H□15□, do not use a spring washer between the mounting screw and product.

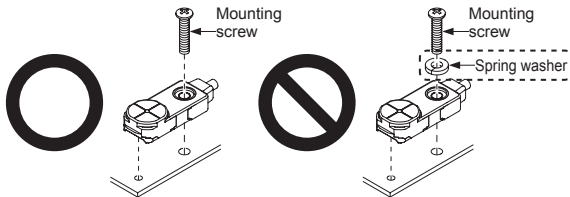

### 2 CONNECTION

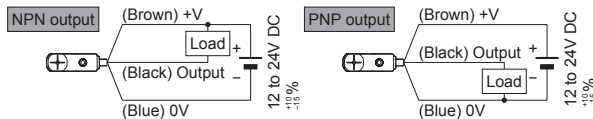

### 3 INTENDED PRODUCTS FOR CE MARKING

Panasonic Industrial Devices SUNX Co., Ltd.

<http://panasonic.net/id/pidsx/global>

Overseas Sales Division (Head Office)

2431-1 Ushiyama-cho, Kasugai-shi, Aichi, 486-0901, Japan

Phone: +81-568-33-7861 FAX: +81-568-33-8591

For sales network, please visit our website.

© Panasonic Industrial Devices SUNX Co., Ltd. 2017