

Picking Switch SL-VPK01

MJEC-SLVPK01 No.0071-43V

Thank you very much for purchasing Panasonic products. Read this Instruction Manual carefully and thoroughly for the correct and optimum use of this product. Kindly keep this manual in a convenient place for quick reference.

WARNING

- Never use this product in a device for personnel protection.
- In case of using devices for personnel protection, use products which meet laws and standards, such as OSHA, ANSI or IEC etc., for personnel protection applicable in each region or country.
- Before handling this product, remove any electrostatic charge that may be present on your body.

1 PART NAMES AND FUNCTIONS

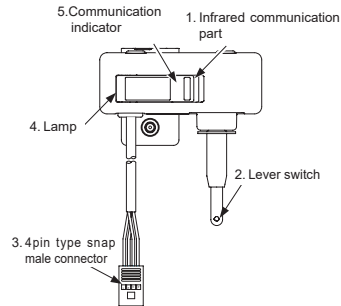

Name	Function
1 Infrared communication part	Exclusive remote control SL-VAR1 (Optional) signal transmission and reception department
2 Lever switch	When the lever switch is tilted 15° or more, the input goes ON.
3 4pin type snap male connector	An SL-CP2 is included as a connector to connect the main cable and branch cable of the S-LINK V. For the terminal arrangement, refer to "1.2 TERMINAL ARRANGEMENT".
4 Lamp	Lights up when the output signal from the signal transmission line goes ON. * Turn off when the output signal from the signal transmission line goes OFF.
5 Communication indicator	Blinks with the synchronized signal from the controller.

2 MOUNTING

Procedure

1. Remove the socket head hex bolt used for fixing the holder [M6 (length 15 mm)].
When doing this, remove the pipe mounting holder as well.
2. Align the connecting piece of the product with the connecting piece of the pipe mounting holder so that the pipe is gripped between these pieces.
You can align the connecting pieces easily by shifting them up and down during alignment work.
3. Install the product using the socket head hex bolt for fixing the holder that you removed in step 1.

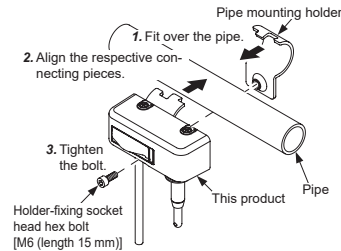

3 TERMINAL ARRANGEMENT

<Terminal arrangement diagram>



Terminal No.	Terminal name	Cable color
1	24V	Brown
2	0V	Blue
3	D	White
4	G	Black

4 CABLE CONNECTION

Be sure to switch off the power before carrying out wiring work.

- When using dedicated cables for the main cable and branch cables of the S-LINK V system, use separately purchased dedicated hook-up connectors.
- Match the colors of the main cable and the branch cables with the color of the cables of this product.

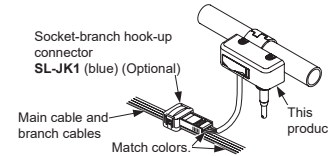

5 OPERATION SETTINGS

- Set the operation by the remote controller **SL-VAR1** (optional) dedicated for setting before using the product. Keep in mind that the product can not be used if the operation is not set.
Setting items : Lever input address ,
Address offset ,
Lamp color

Note: For the settings, refer to the "SL-VAR1 Instruction Manual".

6 SPECIFICATIONS

Product name	Picking Switch
Model No.	SL-VPK01
Supply voltage	24V DC $\pm 10\%$ (Supply from a S-LINK control unit. Alternatively, a separate power supply can be used.)
Current consumption	24V DC line 25mA or less (when lamp is ON)
Communication specification	Based on S-LINK V protocol
Communication mode	B mode, C mode
Address settings	Input address (lever switch): 0 to 255 Output address (lamp): Select an offset of +32, +64, +128 or +256 for the input address
Input operation	When the lever switch is tilted 15° or more, the input goes ON. When the lever switch is pulled 1.6mm or more, the input goes ON. (Note)
Number of I/O	1 lever input and 1 Lamp output
Ambient temperature	0 to +50°C (No dew condensation) Storage: -20 to +60°C
Ambient humidity	35 to 85% RH, Storage: 35 to 85% RH
Material	Product case: Polycarbonate Lamp cover: Polycarbonate Rear case :SGMCC Pipe mounting holder :SPCC
Cable	4-core cabtirc cable 0.15m (With SL-CP2 4pin type snap male connector)
Weight	Approx. 200g (body)
Accessory	ø28 Pipe mounting holder :1pcs Holder-fixing socket head hex bolt [M6×15] :1pcs

Note: Pulling load is less than 19.6N. Make sure that stress by forcible bend or pulling is not applied directly to the lever switch.

7 CAUTIONS

- This product has been developed / produced for industrial use only.
- For installing the product, use an Erector®(Note) Pipe manufactured by Yazaki Kako Corporation or equivalent. Ground the mounting pipe to the frame ground (F.G.). If it is not properly grounded, the product may be damaged due to static electricity accumulated on the pipe.

Note: "Erector" is a registered trademark of Yazaki Kako Corporation.

8 INTENDED PRODUCTS FOR CE MARKING

- This product complies with CE Marking product.



9 ROHS COMPLIANCE

- This product is in compliance with the RoHS Directive .
- The Chinese version of RoHS indicates the contents, regardless of the RoHS regulation values.

Panasonic Corporation

Panasonic Industrial Devices SUNX Co., Ltd.
<https://panasonic.net/id/pidsx/global>

Please visit our website for inquiries and about our sales network.

© Panasonic Industrial Devices SUNX Co., Ltd. 2020

PRINTED IN JAPAN